

horizon

PERFORMANCE SERIES

PLASMAFUGE-12

Model 853VES



FAST
Plasma Preparations
 Platelet-Rich Plasma to
 Platelet Poor / Free Plasma!

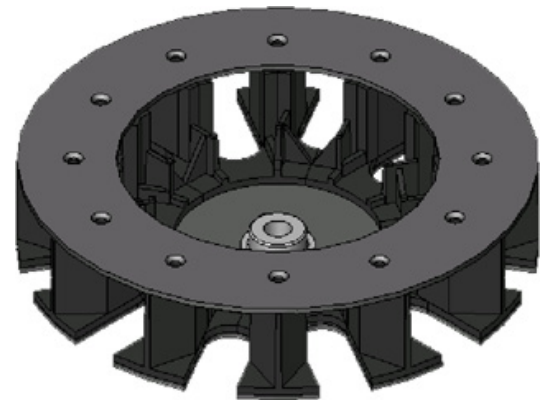

Horizontal Rotor (standard)

- Rapid Separations
- Full Horizontal Separation for Twelve (12) Tubes up to 10mL
- Precise Digital Controls
- ETL Compliant to ANSI/UL Standards; CE Marked

SPECIFICATIONS:

General Specifications for the Horizon, Model 853VES Centrifuge

Overall Dimensions:	Height:	8.5 in. (23 cm)
	Width:	12.5 in. (32 cm)
	Depth:	15.5 in. (39 cm)
Weight:		30 lbs. (13.7 kg)
Centrifuge Motor:		1/2H.P. Brushless DC
Protection Breaker:		4 Amp. Re-settable
Timer:		Electronic, w/hold or 0 to 99 minutes +/- 1%
Max. Power Requirements:		200 Watts
Voltage:		115 / 230 (+/-10%) Volts
Frequency:		50/60 Hz

Why Horizontal Separation?

A horizontal rotor produces better separation with a tighter gel line, eliminating remixing and re-spins.

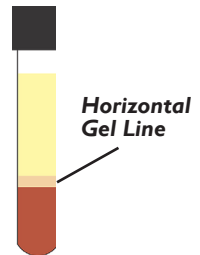

10mL test tubes up to 17mm x 100mm
 15mL test tubes up to 17mm x 125mm
 UL Std. 61010A-1 and UL Std. 61010A-2-20, CAN/CSA C22.2 No. 1010.1 and CAN/CSA C22.2 No. 1010.2.20,
 CE EN 61000-3-2, -3-3, EN 61000-4-2, -4-3, -4-4, -4-5, -4-6, -4-11, EN 61010-1, -2-020

The Horizon Model 853VES, Plasmafuge-12, is a medium capacity centrifuge with unmatched performance. The 853VES offers control over almost every aspect of the unit's operation from variable acceleration and deceleration to easy time and speed input. High speed and force capability produces platelet-poor/free plasma and greatly reduces processing times. The exclusive Drucker horizontal rotor allows for quick and easy sample loading and complete horizontal separation. Save settings in one of 10 memory locations and recall them at the touch of a button.

horizon

PERFORMANCE SERIES

PLASMAFUGE-12

OPERATING FEATURES



- **ELECTRONIC TIMER w/DISPLAY:** Selectable from 1 to 99 minutes, or hold (for continuous operation up to 99 minutes), (+/-1%)
- **ELECTRONIC SPEED CONTROL w/DISPLAY:** Easily set the running speed by RPM or RCF
- **BRUSHLESS DC MOTOR:** For smooth and quiet operation with no routine maintenance
- **VARIABLE ACCELERATION AND DECELERATION:** Customize the run from start to finish
- **END-OF-RUN AUDIBLE INDICATOR:** Sounds when the rotor has stopped to inform the operator that a cycle is completed
- **VARIABLE SPEED:** Precision variable speed control gives the operator the ability to select from 500 RPM to the maximum rotor speed (see table below) in 50 RPM increments
- **QUIET OPERATION WITH LOW VIBRATION:** Double encased motor and Drucker's unique "stability mount" assure quiet performance and low out-of-balance vibration

SAFETY FEATURES

- **AUTOMATIC LID LOCK:** Centrifuge will not run with the lid open; lid cannot be opened while samples are spinning
- **POSITIVE LID LATCHING:** Firm mechanical latching of the lid prevents the escape of debris in case of breakage
- **OUT-OF-BALANCE DETECTION:** If an imbalance is detected, the centrifuge will come to a safe controlled stop
- **WELDED STEEL CONSTRUCTION:** For strength and durability
- **CLEAR LID:** Offers safe observation and access for phototachometer

ROTOR / CARRIER OPTIONS

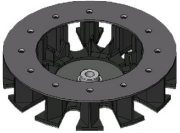
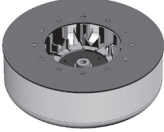
The model 853VES is available with many different rotor and carrier packages to choose from. Select the package which best suits your needs. Consult your authorized dealer or The Drucker Company for additional information.

	PART NO.	# PLACES	MAX TUBE SIZE	SPEED RANGE	FORCE RANGE	
	12-Place Horizontal (Standard)	7786024				
	75mm tube holder,	7713043	12	17mm x 75mm	500 to 4,000 RPM	40 to 2,000 xg
	100mm tube holder	7713040	12	17mm x 100mm	500 to 4,000 RPM	40 to 2,400 xg
	12-Place Performance-Plus Horizontal	7786010				
	75mm tube holder	7713043	12	17mm x 75mm	500 to 5,000 RPM	40 to 3,100 xg
	100mm tube holder	7713040	12	17mm x 100mm	500 to 5,000 RPM	40 to 3,800 xg
	20-Place Fixed-Angle	7786042				
	75mm tube holder	7713043	20	17mm x 75mm	500 to 3,200 RPM	40 to 1,100 xg
	100mm tube holder	7713040	20	17mm x 100mm	500 to 3,200 RPM	40 to 1,220 xg
	125mm tube holder	7713044	20	17mm x 125mm	500 to 3,200 RPM	40 to 1,280 xg
	6-Place 50mL Fixed-Angle	7786044				
	50mL Fixed-angle Carrier	7787051	6	34mm x 125mm	500 to 3,200 RPM	40 to 1,280 xg



100 mm tube holder
p/n 7713040

holder cap
p/n 7713011

75 mm tube holder
p/n 7713043

125 mm tube holder
p/n 7713044

1" Cushion Spacer
p/n 1525

50mL tube holder
fixed-angle
p/n 7787051

1.5 to 2mL tube Adapter
p/n 7713065

13 x 75mm insert, p/n
7713064

13 x 100 mm insert, p/n
7713066

.5 to 1 ml tube Adapter
p/n 7713068

THE DRUCKER CO.
Providing Quality Centrifuges since 1932

Drucker, The Drucker Company, and Horizon are trademarks of The Drucker Company, Inc.
© The Drucker Company 2005-2011. All Rights Reserved

MADE IN THE USA

168 Bradford Drive, Port Matilda, PA 16870 U.S.A.
+1-814-692-7661 • Fax: +1-814-692-7662
www.druckercompany.com